

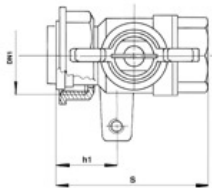

## RIV 7584

Ball valve F/F with tamperproof key locking device,  
 fitting for gas meter and for unified bracket  
 standard bore  
 (EN 331 MOP 5-20)  
 aluminium butterfly handle

### Tech drawings and tables

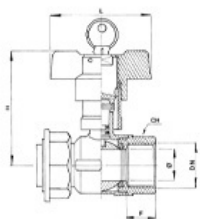

DNxDN1	Code	Ø	H	S	L	F	CH	h1	PN	KG	P/box
1" x 1"1/4	077584000280	20	63	81,5	70	23	38	32,5	5	0,58	5
1" x 1"1/4	077584000272	22	80	82,5	70	23	38	32,5	5	0,75	5
1/2" x 1"1/4	077584000190	12,5	71,5	62	70	16	22,5	32,5	5	0,54	5
1/2" x 3/4"	077584000187	12,5	71,5	62	70	16	22,5	32,5	5	0,47	5
3/4" x 1"1/4	077584000231	16	75	72	70	17,5	31	32,5	5	0,61	5

### Advantages

## Technical data

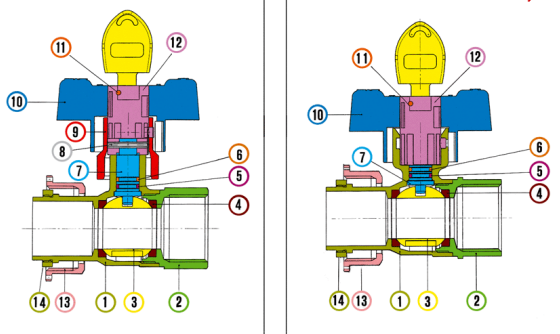

### Materials

Part No.	Part Name	Material	Material Code	Finish
1	Body	Brass	CuZn40Pb2	
2	Body end	Brass	CuZn40Pb2	
3	Ball	Brass	CuZn40Pb2	Chrome-plated
4	Seats	P.T.F.E.		
5	O-Ring	FKM		
6	O-Ring	NBR		
7	Stem	Brass	CuZn39Pb3	
8	Elastic pin	Steel		
9	Screwed ring	Zinc alloy	ZnAl4Cu1	
10	Butterfly handle	Aluminium	GD-AISI12Cu2Fe	Yellow
11	Elastic pin	Steel		
12	Locking device	Zinc alloy	ZnAl4Cu1	
13	Swivel nut	Brass	CuZn40Pb2	
14	Screwed ring	Brass	CuZn39Pb3	

### Connections

Female ISO 7/1Rp (parallel), screwed ring ISO 228/1

### Limit

-20°+70° (without liquid)

### Notes

The max.working pressure (PN) means at a room temperature of about 23°C.

## Pressure Loss Chart

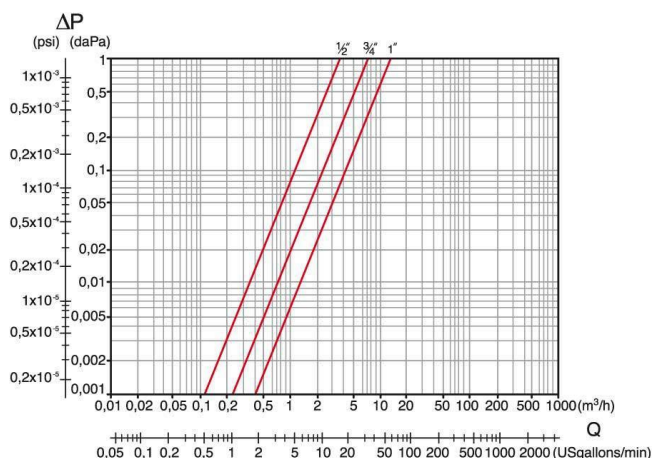

## Temperature/Pressure

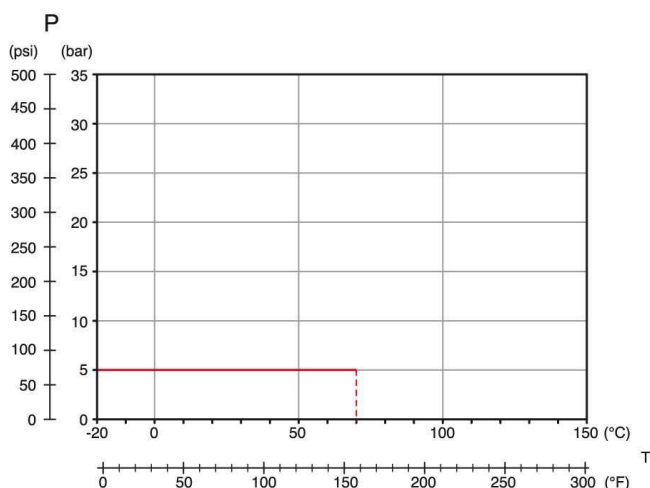

## Kv & Cv Coefficients

### Size Kv Cv

1" 42,0 -

3/4" 24,0 -

1/2" 11,5 -

## Approvals

